

THE PARLIAMENT OF THE
COMMONWEALTH OF AUSTRALIA

JOINT STANDING COMMITTEE
ON THE NEW PARLIAMENT HOUSE

SECOND REPORT RELATING TO
A COMMUNITY BASED CHILD CARE CENTRE
IN THE PARLIAMENTARY ZONE

MEMBERSHIP OF THE JOINT STANDING COMMITTEE ON THE
NEW PARLIAMENT HOUSE
(Thirty-fifth Parliament)

Joint Chairmen

Senator the Hon K.W. Sibraa
President of the Senate

The Hon L.B. McLeay
Speaker of the House of Representatives

Members

Hon S.J. West
Minister for Administrative Services

Senator M.E. Baume

Senator M.A. Colston

Senator A.R. Devlin

Senator M.E. Reid

Senator C.C. Schacht

Senator A.E. Vanstone

Hon J.D.M. Dobie

Mr S.C. Dubois, MP

Mr T.A. Fischer

Mr M.J. Lee

Mr M.J.R. MacKellar

Acting Secretary to the Committee

Ms D. Dixon

BACKGROUND

Sub-paragraph 4(b) of the resolution of appointment of the Joint Standing Committee on the New Parliament House provides:

"That the Committee also consider and report on matters coming within the terms of section 5 of the Parliament Act 1974 as may be referred to it by the Minister responsible for administering the the National Capital Development Commission Act 1957."

In a letter received on 1 December 1988, the Minister for the Arts and Territories referred a proposal to establish a community based child care centre adjacent to the provisional Parliament House to the Joint Standing Committee on the New Parliament House for inquiry and report.

The proposal was tabled in the House of Representatives on 1 December 1988 and the Senate on 5 December 1988.

As the proposed work is within the Parliamentary zone it will be necessary for the proposal to be approved by each House in accordance with subsection 5(1) of the Parliament Act 1974.

Subsection 5(1) of the Parliament Act 1974 provides:

- "5.(1) No building or other work is to be erected on land within the Parliamentary Zone unless:
- (a) if the land is within the precincts as defined by subsection 3(1) of the Parliamentary Precincts Act 1988 - the President of the Senate and the Speaker of the House of Representatives jointly have; or
 - (b) in any other case - the Minister has;
caused a proposal for the erection of the building or work to be laid before each House of the Parliament and the proposal has been approved by resolution of each House."

THE PROPOSAL

In November 1988 the Cabinet agreed to the establishment of a community based child care centre adjacent to the provisional Parliament House.

The proposed location and site were considered by the Committee at its meeting of 6 March 1989 and the Committee recommended to the Parliament on 9 March 1989 as follows:

The Committee recommends approval of the following work in the Parliamentary Zone:

the establishment of a community based child care centre adjacent to the provisional Parliament House as shown in the attached National Capital Development Commission plan.

Copies of location and site plans are attached.

The Committee has now met to consider plans for the child care centre. Copies of the plans are attached. The Committee has also examined the recommendations of the of the Old Parliament House Gardens - Conservation Study and Management Plan provided by the National Capital Planning Authority together with comments on the proposed child care centre from the Australian Heritage Commission. The Committee has considered the issues and agrees that the site adjacent to the provisional Parliament House is the most appropriate location for the community based child care centre.

RECOMMENDATION

The Committee recommends approval of the following work in the Parliamentary Zone:

the establishment of a community based child care centre adjacent to the provisional Parliament House as shown in the attached location and site plans;

and further recommends

approval of the attached National Capital Planning Authority building plans.

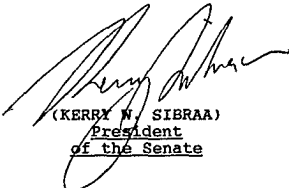

(KERRY N. SIBRAA)
President
of the Senate



(LEO McLEAY)
Speaker of the House
of Representatives

20 December 1989

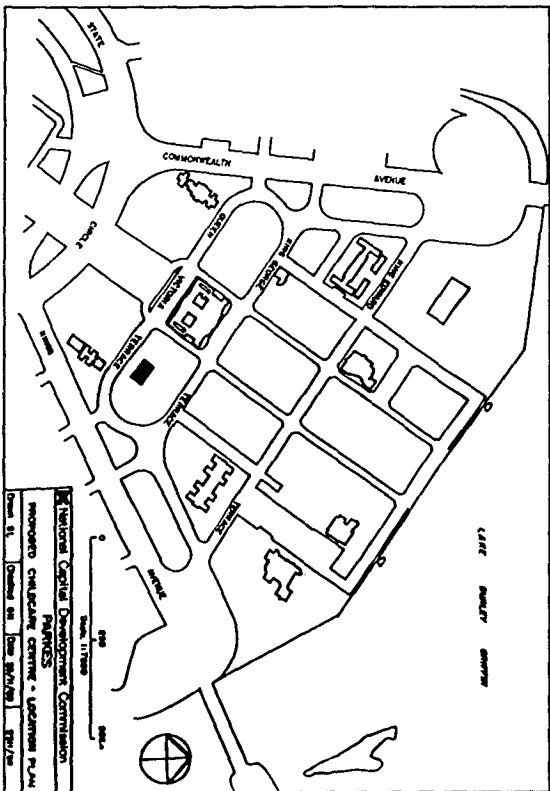

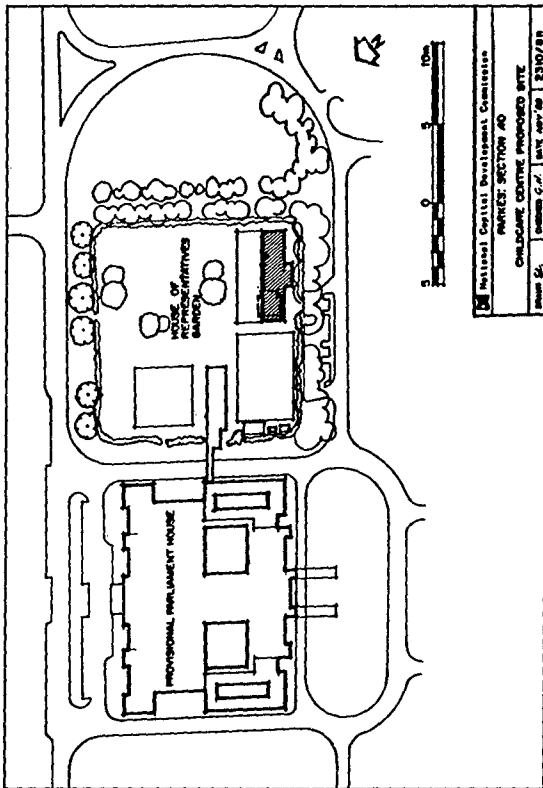

National Capital Development Committee
 PARKS: SECTION 4D
 CHURCHILL CENTRE PROPOSED SITE
 DRAWN BY: [unclear] DATE: APR 1981 23/10/81

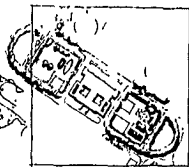

THE PROPOSAL:
 TO PLACE A CHILD CARE CENTRE WITHIN THE HOPE OF REPRESENTATIVES GARDEN. THE GARDENS ON EITHER SIDE OF PROVISIONAL PARLIAMENT PLACE ARE TO BE OPENED TO THE PUBLIC. NO OTHER BUILDINGS ARE PROPOSED WITHIN THESE GARDENS - EXISTING ONES ARE TO BE DEMOLISHED. THE AREA OF THE CENTRE IS SUBSTANTIAL (APPROX. 10000 SQ. METRE) WITH A FEW PLAY AREAS GIVING TOTAL COVERAGE OF APPROX. 7000M².

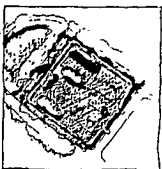

AS A PAVILION:
 WHILE THE CENTRE COULD BE TREATED AS A PAVILION IN A PUBLIC GARDEN, THE SCALE OF THE BUILDING COULD BE OVERSTRESSINGLY DOMINANT & POTENTIALLY BE SEEN AS AN INTRUSIVE AND 'PRIVATE' ELEMENT IN AN OTHERWISE PUBLIC LANDSCAPE SETTING.

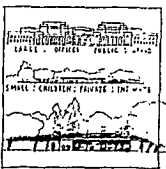

ARCHITECTURAL STYLE:
 FUNCTIONAL REQUIREMENTS AND COST LIMITATIONS DEMAND SIMPLE FORM AND CONSTRUCTION. REFERENCE TO THE ARCHITECTURAL STYLE OF NEIGHBOURING BUILDINGS (IE. PPA & EAST BLOCK) COULD ONLY BE SUPERFICIAL. THIS, AND THE RELATIVE ISOLATION OF THE SITE BY TREES AND HEDGES, SUGGESTS LITTLE TO BE GAINED IN PURSUING AN OPTION OF 'SYMPATHETIC' ARCHITECTURE. IT SEEMS MORE APPROPRIATE TO TAKE A DESIGN CUE FROM SURROUNDING LANDSCAPE FORMS (IE. THE HEDGE & GARDEN (1900S)) AND THE 'ARCHITECTURE' DOWNPLAYED.

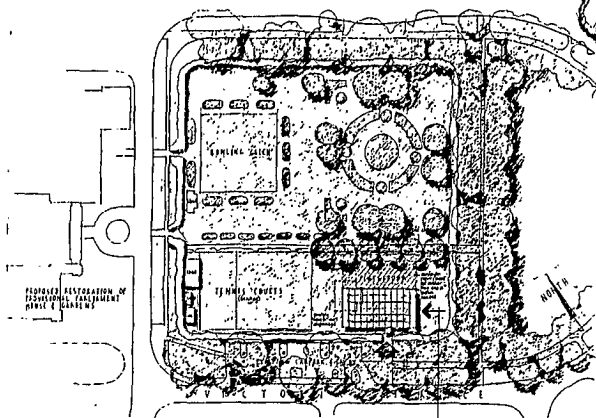

SITE PLAN SCALE 1:500
 Proposed Child Care Centre

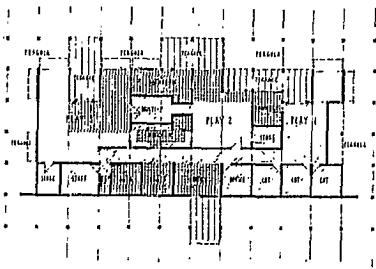

FLOOR PLAN SCALE 1:100

PROPOSED PARLIAMENTARY ZONE CHILD CARE CENTRE

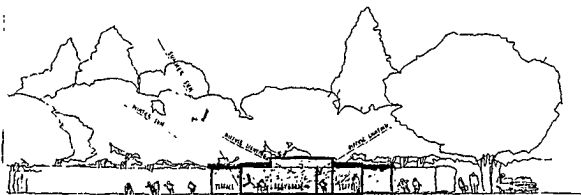

CROSS SECTION SCALE: 1:100.

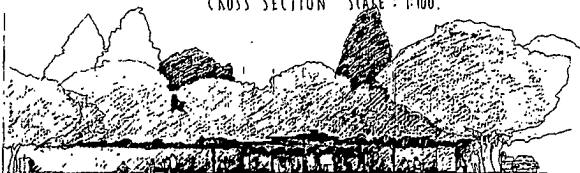

WEST ELEVATION SCALE: 1:100



VIEW FROM WEST

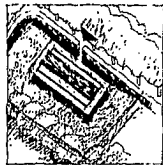

THE BUILDING AS PERGOLA:
CONSIDER THE BUILDING AS A
SIMPLE RECTANGULAR LIGHT-
WEIGHT STRUCTURE CONTAINED
ENTIRELY WITHIN A CREEPER
(DECIDUOUS & EVERGREEN)
COVERED PERGOLA.

THE PERGOLA/VERANDAH
DIMINISHES THE IMPACT OF THE
BUILDING VOLUME AND ALLOWS
IT TO REcede INTO THE
SURROUNDING LANDSCAPE.

THE ROOF IS TREATED AS A SERIES
OF SIMPLE SLOPING PLANES HELD
BACK FROM THE PERGOLA EDGE,
EFFECTIVELY HIDDEN FROM VIEW.



PERGOLA TREATMENT:

THE PERGOLA IS A STEEL FRAMED
STRUCTURE, 2.5M HIGH, PAINTED
DARK GREEN WITH STAINLESS STEEL
WIRES STRETCHED LONGITUDINALLY
BETWEEN HORIZONTAL MEMBERS.

DECIDUOUS / EVERGREEN CREEPERS
ALLOW WINTER SUN PENETRATION/
SUMMER PROTECTION; THEIR
EXTENT DEPENDING ON WINDOW
SIZE & LOCATION.

WINTER PROTECTION WHERE
REQUIRED, IS PROVIDED BY
SUSPENDED FIXED PANELS.

PROPOSED PARLIAMENTARY ZONE CHILD CARE CENTRE

THE PARLIAMENT OF THE
COMMONWEALTH OF AUSTRALIA

JOINT STANDING COMMITTEE
ON THE NEW PARLIAMENT HOUSE

DISSENTING REPORT

SENATOR REID
SENATOR VANSTONE
HON MACKELLAR, MP
SENATOR BAUME

DISSENTING REPORT

We dissent to the resolution relating to a child care centre in the Parliamentary Zone in the Joint Standing Committee on the New Parliament House Report of 21 December 1989, on the grounds, amongst others, that a suitable site for a child care facility has already been identified in the near vicinity but outside the Parliamentary Triangle. Using this site would allow the House of Representatives garden of the provisional Parliament House to be restored as far as practicable to its original layout and condition.



SENATOR M E REID



SENATOR A E VANSTONE



HON M J R MACKELLAR

21 December 1989

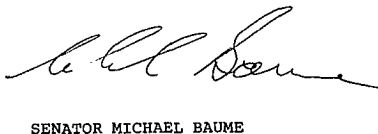

SENATOR MICHAEL BAUME