

1987-88-89

THE PARLIAMENT OF THE COMMONWEALTH OF AUSTRALIA

JOINT STANDING COMMITTEE ON THE NEW PARLIAMENT HOUSE

REPORT RELATING TO
A COMMUNITY BASED CHILD CARE CENTRE
IN THE PARLIAMENTARY ZONE

MEMBERSHIP OF THE JOINT STANDING COMMITTEE ON THE
NEW PARLIAMENT HOUSE

(Thirty-fifth Parliament)

Joint Chairmen

Hon J. Child, MP
Speaker of the House of Representatives

Senator the Hon K.W. Sibraa
President of the Senate

Members

Hon S.J. West, MP
Minister for Administrative Services

Senator M.E. Baume

Senator M.A. Colston

Senator A.R. Devlin

Senator D.J. MacGibbon

Senator M.E. Reid

Senator C.C. Schacht

Hon J.D.M. Dobie

Mr S.C. Dubios, MP

Mr M.J. Lee, MP

Mr L.B. McLeay, MP
Deputy Speaker and Chairman of Committees

Mrs K.J. Sullivan, MP

Acting Secretary to the Committee

Ms D. Dixon

BACKGROUND

Sub-paragraph 4(b) of the resolution of appointment of the Joint Standing Committee on the New Parliament House provides:

"That the Committee also consider and report on matters coming within the terms of section 5 of the Parliament Act 1974 as may be referred to it by the Minister responsible for administering the National Capital Development Commission Act 1957."

In a letter received on 1 December 1988, the Minister for the Arts and Territories referred a proposal to establish a community based child care centre adjacent to the provisional Parliament House to the Joint Standing Committee on the New Parliament House for inquiry and report.

The proposal was tabled in the House of Representatives on 1 December 1988 and the Senate on 5 December 1988.

As the proposed work is within the Parliamentary zone it will be necessary for the proposal to be approved by each House in accordance with subsection 5(1) of the Parliament Act 1974.

Subsection 5(1) of the Parliament Act 1974 provides:

"5.(1) No building or other work is to be erected on land within the Parliamentary zone unless:

- (a) if the land is within the precincts as defined by subsection 3(1) of the Parliamentary Precincts Act 1988 - the President of the Senate and the Speaker of the House of Representatives jointly have; or
- (b) in any other case - the Minister has;

caused a proposal for the erection of the building or work to be laid before each House of the Parliament and the proposal has been approved by resolution of each House."

THE PROPOSAL

In November 1988 Cabinet agreed to the establishment of a community based child care centre adjacent to the provisional Parliament House. Funding for the centre has been included in the National Capital Development Commission's 1988-89 Capital Works program.

The need for child care in the Parliamentary zone was first identified in 1981 and has been raised in the ACT community by the Status of Women Caucus Committee, the child care sub-committee of the Joint Standing Committee on the New Parliament House and the Australian Council of Trade Unions. The ACT Children's Services Program Planning Committee also identified the Parliamentary zone as a high-need area for child care.

The proposed centre will provide 40 places for full day care, and a further 30 places for occasional care. The centre responds to the need of a wide range of user groups, in particular local residents and the growing number of tourists requiring child care while visiting major attractions in the Parliamentary zone including the recently opened National Science and Technology Centre, the Australian National Gallery, High Court of Australia, National Library of Australia and Parliament House.

The centre and associated site works are estimated to cost \$0.7m and, subject to approval, construction will start in the first half of 1989.

The attached plans show the proposed location of the child care centre.

CONCLUSION

The Committee agrees with the establishment of a community based child care centre adjacent to the provisional Parliament House.

RECOMMENDATION

The Committee recommends approval of the following work in the Parliamentary Zone:

- the establishment of a community based child care centre adjacent to the provisional Parliament House as shown in the attached National Capital Development Commission plan.

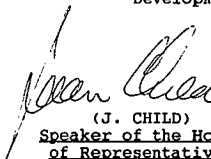

(J. CHILD)
Speaker of the House
of Representatives

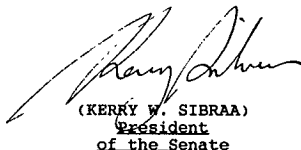

(KERRY W. SIBRAA)
President
of the Senate

9 March 1989

LAKE BURLEY GRIFFIN



0 250 500.0
Scale: 1:17500

National Capital Development Commission

PARKES

PROPOSED CHILDCARE CENTRE - LOCATION PLAN

Drawn by: Chestnut EN Date: 28/11/98 E31/98

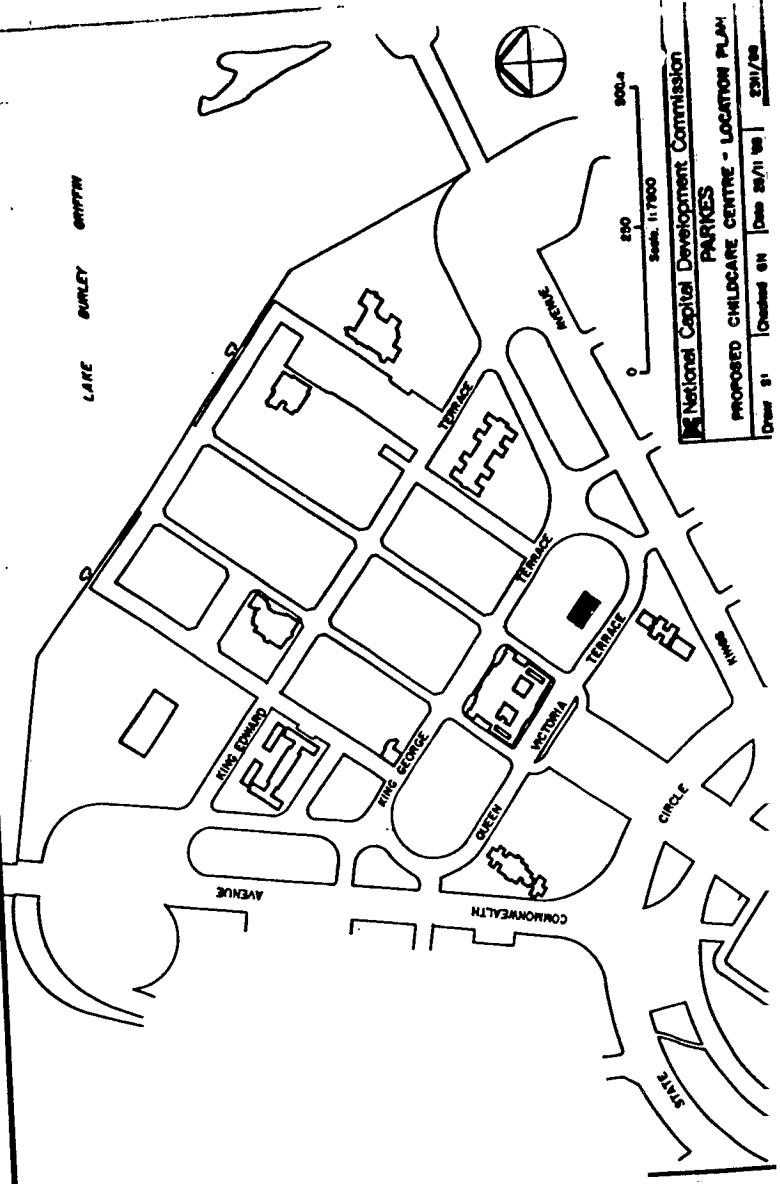

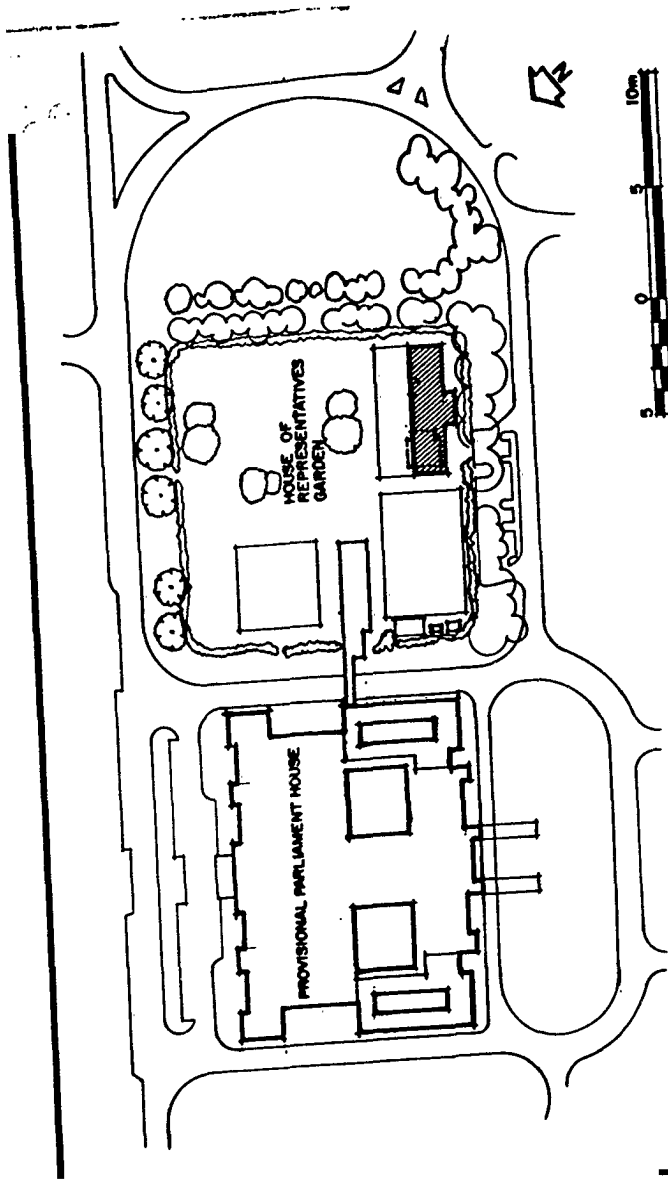

National Capital Development Commission

PARKS: SECTION 40

CHILDCARE CENTRE PROPOSED SITE

DRAWN BY: [unclear] CHECKED C.A. DATE 4/8/88 23/10/88

1987-88-89

THE PARLIAMENT OF THE COMMONWEALTH OF AUSTRALIA

JOINT STANDING COMMITTEE ON THE NEW PARLIAMENT HOUSE

MINORITY REPORT RELATING TO

A CHILD CARE CENTRE IN

THE PARLIAMENTARY ZONE

MINORITY REPORT

While recognising the need for a child care centre in or near the Parliamentary Zone, we are concerned about the Heritage implications of any new building erected "adjacent" to the old Parliament House, particularly if the old House is to be restored to its 1927 state in an appropriately landscaped area.

As a result, a decision on a suitable location should not be taken before the Government advises the Committee of its proposals for the future of the old Parliament House.

We regret the majority decision not only to agree to the proposal immediately but also to reject our request for the Government to provide an urgent response to the Committee on the future of the old Parliament House before construction proceeds on the Child Care Centre.

We are also concerned that the proposal, which specifies a community based centre funded from the A.C.T.'s Federal Government allocation, contains no details of estimated demand for a publicly funded centre, of charges to be applied or priorities to be followed in accepting children, many of whom it appears will be from parents having no involvement in the Parliamentary Zone other than it being on, or near, their routes from their homes to their places of work.

In our view it is inappropriate for any construction to take place in the Parliamentary Zone that does not have a strict and direct relevance to that Zone.



SENATOR M E BAUME



SENATOR D J MacGIBBON



SENATOR M E REID

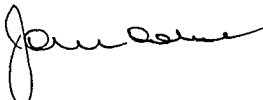

HON J D M DOBIE, MP,

9th March 1989